

⚠ WARNING

DO NOT EXCEED WORKING LOAD LIMIT.
USE ONLY G80 & G100 COMPATIBLE COMPONENTS FOR OVERHEAD LIFTING.



Safe Lifters

Pundol Apartments, Shop No. 5 & 6, 160 M.G. Road,
Pune - 411001, (India) Tel +91 20 66013783 / 84 / 85 / 86
Fax +91 20 26350832 Email : safelifters@eth.net

Dee Shackles IS 6132 (Part - II)

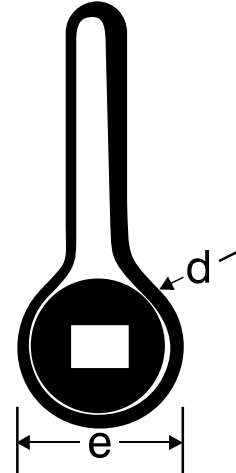
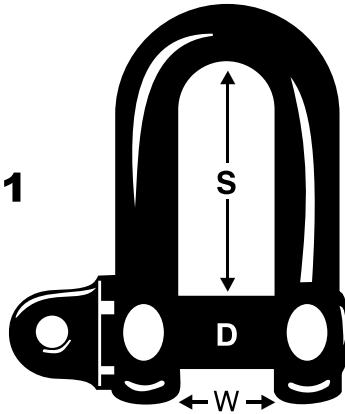
**SL - 211**

JAW INSIDE WIDTH W	INSIDE LENGTH S=2.5 W	BODY MATERIAL DIA d	PIN DIA D min	EYE OUTSIDE DIA e min	SAFE WORKING LOAD TONNES		
					GRADE 30	GRADE 40	GRADE 63
18	40	10	12	24	-	-	1.0
20	44	12	14	28	-	1.0	1.25
22	49	14	16	38	1.0	1.6	2.6
25	55	16	19	38	1.25	1.6	2.0
28	62	17	20	40	1.6	2.0	2.5
32	70	19	22	44	2.0	2.5	3.2
34	79	22	26	52	2.5	3.2	4.0
40	88	24	28	56	3.2	4.0	5.0
45	99	28	32	62	4.0	5.0	6.3
50	110	32	35	70	5.0	6.3	8.0
56	124	35	40	78	6.3	8.0	10
63	139	38	44	88	8.0	10	12.5
70	154	45	50	100	10.0	12.5	16
80	178	48	55	110	12.5	16	20
90	198	54	62	124	16	20	25
100	220	60	69	138	20	25	32
107	236	66	76	152	25	32	40
117	258	70	82	164	32	40	45
130	286	80	91	182	40	45	63
140	308	85	97	197	50	63	80
155	337	93	110	220	63	80	-

Specifications given are indicative and are subject to change.

Note : The pin diameters actually used may be based on any standard series for sizes of bar material provided that the intervals between adjacent sizes do not exceed the R20 Interval (1.12) The next size above the minimum pin diameter, D min as given in the above table should be used. The Nominal diameter D used is then subject to the tolerances specified in 5.2 of IS:6132 (Part I). 1971 The eye outside diameter then becomes twice the nominal Pin Diameter D subject to the tolerances in 5.2 of IS:6132 (Part II) - 1971.

Specification for Shackles : Part I General Requirement for grade 30, 40, and 63 only.

Shackles of Grade 30, 40, 63 confirm to I.S.I specification 6132